

# THE SPOTNICKS

backline list/Japan '98

## SAPPORO backline list

### BO WINBERG (LEAD GUITAR)

- 1x Marshall JCM900 1960B Cabi guitars (carry in)
- lots picks/strings (carry in)
- lots cables (inst/SP)

### BOB LANDER (RHYTHM GUITAR)

- 1x Marshall JCM900 1960B Cabi guitars (carry in)
- lots picks/strings (carry in)
- lots cables (inst/SP)

### RALPH NILSSON (SECOND GUITAR)

- 1x FENDER TWIN REVERB 1965 MODEL guitars (carry in)
- lots picks/strings (carry in)
- lots cables (inst/SP)

### STEFAN ERIKSSON (BASS)

- 1x TRACE ELLIOT AH350X Amp
- 1x TRACE ELLIOT 1048 Cabi bass guitars (carry in)
- lots picks/strings (carry in)
- lots cables (inst/SP)

### BJORN FRYKUND (DRUMS)

#### YAMAHA RECORDING CUSTOM SET

- 1x 22"x16" Kick drums
- 1x 12"x10" rack tom
- 1x 16"x16" floor tom
- 1x 14"x6 1/2" snare drum

#### Hardwear

- 4x cymbal stand
- 1x hi-hat stand (DW) cymbals (carry in)
- 1x snare stand
- 1x tom holder
- 1x double kick pedal (DW)
- 1x drum throne
- lots drum sticks (carry in)

#### accessories

- 1x Fender Stratocaster (VWT Rose)
- 8x guitar stands
- 1x 100V⇒120V transformer/AC TAP
- lots 9-volt alkaline batteries

\*If 9-volt batteries are used, I need to receive payment.

# THE SPOTNICKS

backline list/Japan '98

OSAKA backline list

## BO WINBERG (LEAD GUITAR)

1x Marshall JCM900 1960A Cabi  
guitars (carry in)  
lots picks/strings (carry in)  
lots cables (inst/SP)

## BOB LANDER (RHYTHM GUITAR)

1x Marshall JCM900 1960A Cabi  
guitars (carry in)  
lots picks/strings (carry in)  
lots cables (inst/SP)

## RALPH NILSSON (SECOND GUITAR)

1x FENDER TWIN REVERB 1965MODEL  
guitars (carry in)  
lots picks/strings (carry in)  
lots cables (inst/SP)

## STEFAN ERIKSSON (BASS)

1x TRACE ELLIOT AH500 Amp  
1x TRACE ELLIOT 1048 Cabi  
bass guitars (carry in)  
lots picks/strings (carry in)  
lots cables (inst/SP)

## BJORN FRYKUND (DRUMS)

### DW DRUM SET

1x 22"x16" kick drums  
1x 12"x 8" rack tom  
1x 16"x14" floor tom  
1x 14"x6 1/2"snare drum

### Hardwear

4x cymbal stand cymbals (carry in)  
1x hi-hat stand (DW)  
1x snare stand  
1x tom holder  
1x double kick pedal (DW)  
1x drum throne  
lots drum sticks (carry in)

### accessories

1x Fender Stratocaster (VWT Rose)  
8x guitar stands  
1x 100V⇒120V transformer/AC TAP  
lots 9-volt alkaline batteries

\*If 9-volt batteries are used, I need to receive payment.

# THE SPOTNICKS

backline list/Japan '98

TOKYO AKASAKA backline list

## BO WINBERG (LEAD GUITAR)

- 1x Roland JC-120 Combo  
guitars (carry in)
- lots picks/strings (carry in)
- lots cables (inst/SP)

## BOB LANDER (RHYTHM GUITAR)

- 1x Fender Tonemaster  
guitars (carry in)
- lots picks/strings (carry in)
- lots cables (inst/SP)

## RALPH NILSSON (SECOND GUITAR)

- 1x FENDER TWIN REVERB  
guitars (carry in)
- lots picks/strings (carry in)
- lots cables (inst/SP)

## STEFAN ERIKSSON (BASS)

- 1x Fender BXR Bass Amp (300watt)
- 1x Fender 1x15" Cabi  
bass guitars (carry in)
- lots picks/strings (carry in)
- lots cables (inst/SP)

## BJORN FRYKUND (DRUMS)

- PEARL DRUM SET
- 1x 20" kick drums
- 1x 10" rack tom
- 1x 12" rack tom
- 1x 14" floor tom
- 1x 14"x6 1/2" snare drum

## Hardwear

- 2x cymbal stand
- 1x hi-hat stand (DW) cymbals (carry in)
- 1x snare stand
- 1x tom holder
- 1x double kick pedal (DW)
- 1x drum throne
- lots drum sticks (carry in)

## accessories

- 1x Fender Stratocaster (VWT Rose)
- 8x guitar stands
- 1x 100V⇒120V transformer/AC TAP
- lots 9-volt alkaline batteries

\*If 9-volt batteries are used, I need to receive payment.

# THE SPOTNICKS

backline list/Japan '98

KAWASAKI CLUB CITTA backline list

## BO WINBERG (LEAD GUITAR)

1x Marshall JCM900 1960B Cabi  
guitars (carry in)  
lots picks/strings (carry in)  
lots cables (inst/SP)

## BOB LANDER (RHYTHM GUITAR)

1x Marshall JCM900 1960B Cabi  
guitars (carry in)  
lots picks/strings (carry in)  
lots cables (inst/SP)

## RALPH NILSSON (SECOND GUITAR)

1x FENDER TWIN REVERB  
guitars (carry in)  
lots picks/strings (carry in)  
lots cables (inst/SP)

## STEFAN ERIKSSON (BASS)

1x TRACE ELLIOT AH600SMX Amp  
1x TRACE ELLIOT 1518 Cabi  
bass guitars (carry in)  
lots picks/strings (carry in)  
lots cables (inst/SP)

## BJORN FRYKUND (DRUMS)

### DW DRUM SET

1x 22"x18" kick drums  
1x 12"x10" rack tom  
1x 16"x14" floor tom  
1x 14"x6 1/2" snare drum

### Hardwear

4x cymbal stand cymbals (carry in)  
1x hi-hat stand  
1x snare stand  
1x tom holder  
1x double kick pedal  
1x drum throne  
lots drum sticks (carry in)

### accessories

1x Fender Stratocaster (VWT Rose)  
8x guitar stands  
1x 100V⇒120V transformer/AC TAP  
lots 9-volt alkaline batteries

\*If 9-volt batteries are used, I need to receive payment.

ZANADU STAGE SIZE  
ザナドゥ ステージサイズ

'98 10/7 THE SPOTMICKS. SPORO ZANADU  
height to ceiling  
●底天井高さ 2015/mm  
OPEN 16:30  
START 19:00

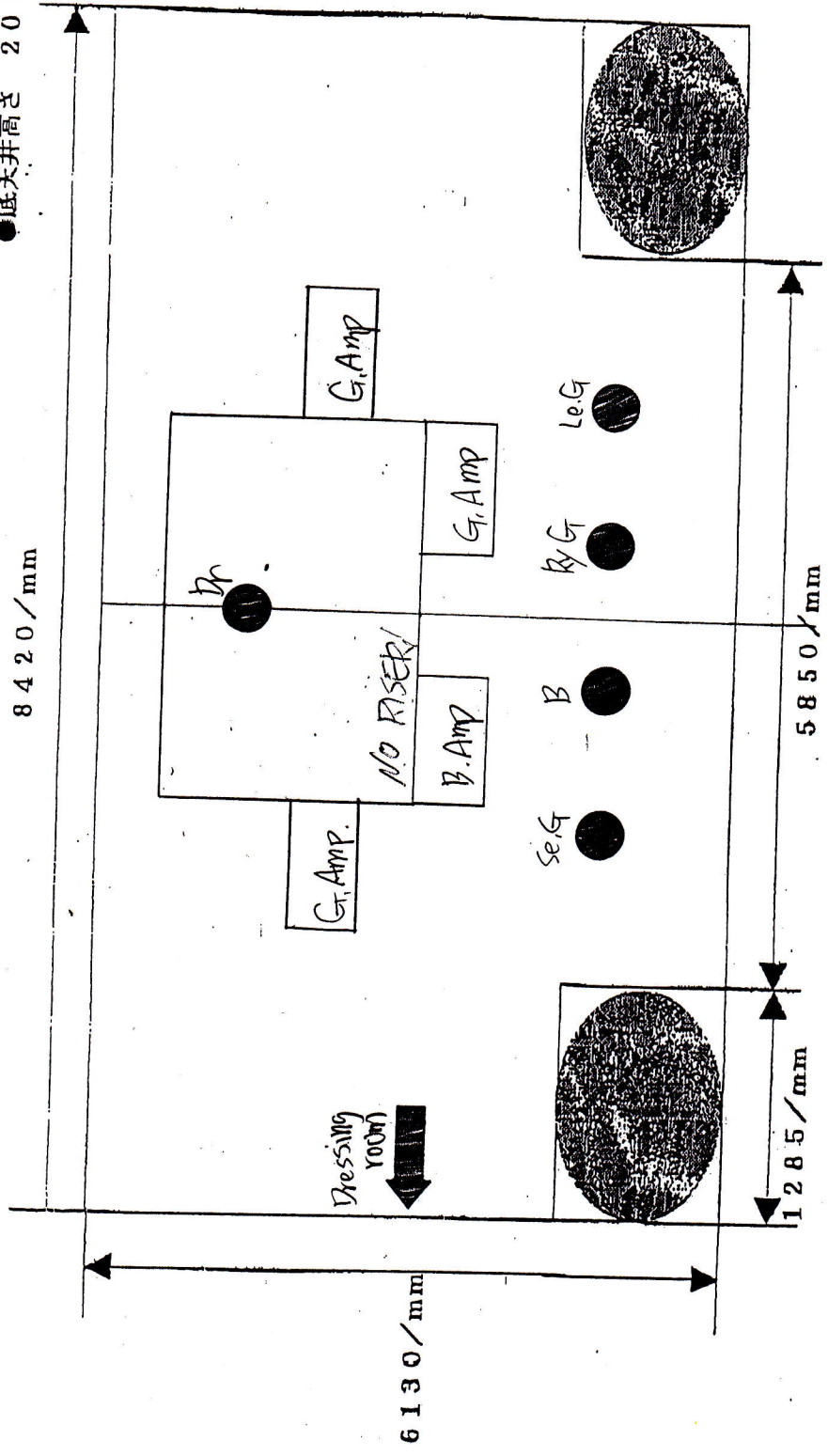

- 高さ通常 450/mm (usual height)
- 上げた状態 850/mm (height when raised)

'98. 10/8 THE SPOTNICKS OSAKA BANANA HALL

Open 18:00  
Start 19:30

10800

5400

5400

2600

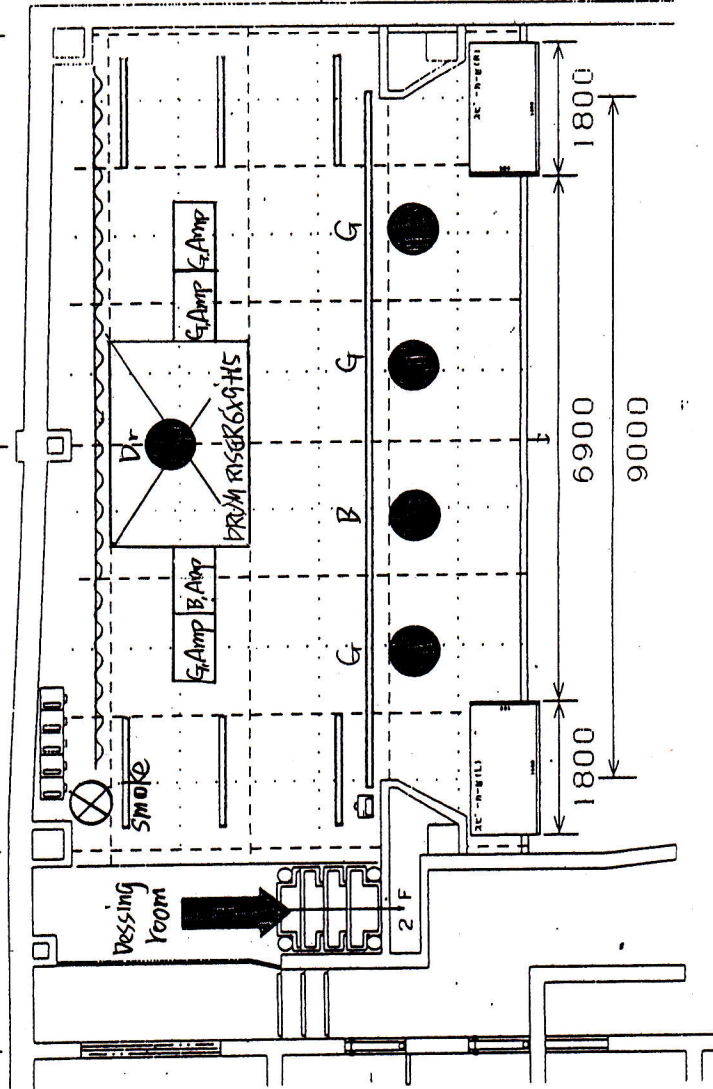

5600

大黒幕  
2SUS/8ch  
袖幕  
UH/文字幕  
鼓スクリン  
袖幕  
ハット  
1SUS/8ch  
袖幕  
割幕

530 大阪市北区堂山16-3

BANANA HALL

OFCEビル1F  
TEL06-3611-6821  
FAX06-3611-1088

98 10/11 THE SPOTNICKS KAWASAKI CLUB CITYA

Open 15:00 open 18:00  
 Start 15:30 start 18:30

CLUB CITYA

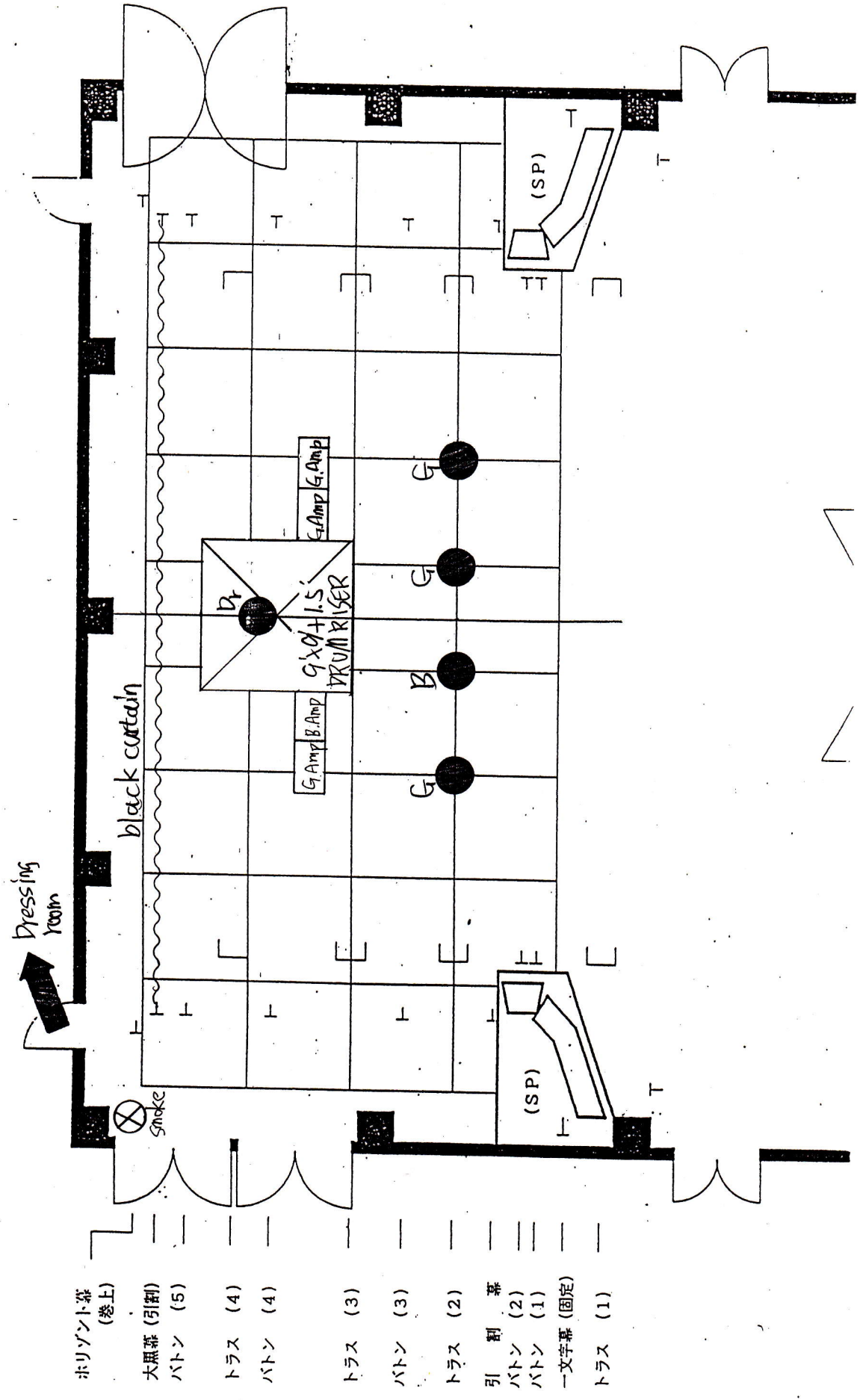

- ホリゾント幕 (巻上)
- 大黒幕 (引割) バトン (5)
- トラス (4) バトン (4)
- トラス (3) バトン (3)
- トラス (2) 引割幕
- バトン (2) バトン (1)
- 一文字幕 (固定) トラス (1)

# THE SPOTNICKS

time table/Japan 1998

## OCTOBER 7 SAPPORO ZANADU

11:00	Club Citta' crew, backline load in setting PA system, lighting system	クラブチッタスタッフ会場入・楽器搬入 音響・照明仕込み開始
13:00	lighting suspension up setting stage, backline	照明吊り込み完了 ステージ上仕込み開始
14:00	lighting focus start (Please don't make any sounds!)	照明シュート開始
15:00	lighting focus up PA (house, monitor) tuning	照明シュート終了 PAチューニング
16:00	THE SPOTNICKS sound check+rehearsal (90min)	<u>THE SPOTNICKS get in venue</u> band=13:00
17:30	sound check finish correcting PA, lighting	各セクション最終チェック
18:30	DOORS OPEN	
19:00	THE SPOTNICKS on stage (90min)	
20:30	END	



# THE SPOTNICKS

time table/Japan 1998

## OCTOBER 8 OSAKA BANANA HALL

11:00	Club Citta' crew, backline load in setting PA system, lighting system	クラブチッタスタッフ会場入・楽器搬入 音響・照明仕込み開始
13:00	lighting suspension up setting stage, backline	照明吊り込み完了 ステージ上仕込み開始
14:00	lighting focus start (Please don't make any sounds!)	照明シュート開始
15:00	lighting focus up PA (house, monitor) tuning	照明シュート終了 PAチューニング
16:00	THE SPOTNICKS sound check+rehearsal (90min)	<u>THE SPOTNICKS get in venue</u> band=13:00
17:30	sound check finish correcting PA, lighting	各セクション最終チェック
18:00	<b>DOORS OPEN</b>	
19:30	THE SPOTNICKS on stage (90min)	
21:00	END	

# THE SPOTNICKS

time table/Japan 1998

## OCTOBER 10 TOKYO AKASAKA EL CAMINO

13:00 — Club Citta' crew, backline load in  
setting PA system  
setting stage, backline

15:00 — PA (house, monitor) tuning

16:30 — THE SPOTNICKS  
sound check+rehearsal (60min)

17:30 — sound check finish  
correcting PA, lighting

18:00 — DOORS OPEN

19:00 — THE SPOTNICKS  
on stage (60min)

20:00 — END

クラブチッタスタッフ会場入・楽器搬入  
音響  
ステージ上仕込み開始

PAチューニング

THE SPOTNICKS get in venue

band=15:30

各セクション最終チェック

# THE SPOTNICKS

time table/Japan 1998

## OCTOBER 11 KAWASAKI CLUB CITTA'

9:00	Club Citta' crew, backline load in setting PA system, lighting system	クラブチッタスタッフ会場入・楽器搬入 音響・照明仕込み開始
10:00	lighting suspension up setting stage, backline	照明吊り込み完了 ステージ上仕込み開始
11:00	lighting focus start (Please don't make any sounds!)	照明シュート開始
12:00	lighting focus up PA (house, monitor) tuning	照明シュート終了 PAチューニング
13:00	THE SPOTNICKS sound check+rehearsal (90min)	<u>THE SPOTNICKS get in venue</u> band=11:00
14:30	sound check finish correcting PA, lighting	各セクション最終チェック
15:00	DOORS OPEN	
15:30	THE SPOTNICKS on stage (90min)	
17:00	END	
18:00	DOORS OPEN	
18:30	THE SPOTNICKS on stage (90min)	
20:00	END	